

CITY OF WHITE CLOUD

NEWAYGO COUNTY, MICHIGAN

WATER DISTRIBUTION SYSTEM GENERAL PLAN

August, 2017

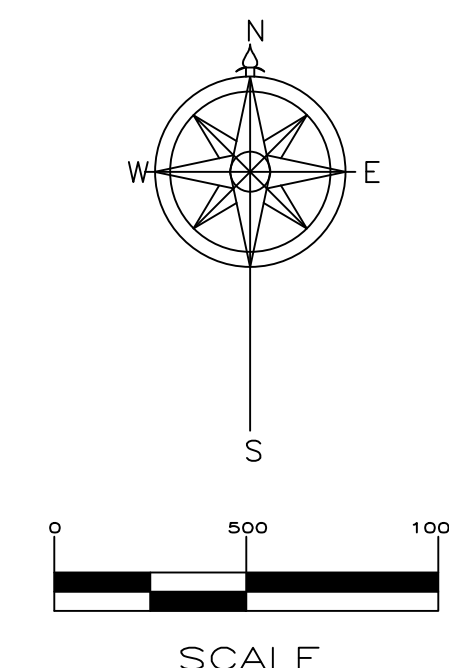
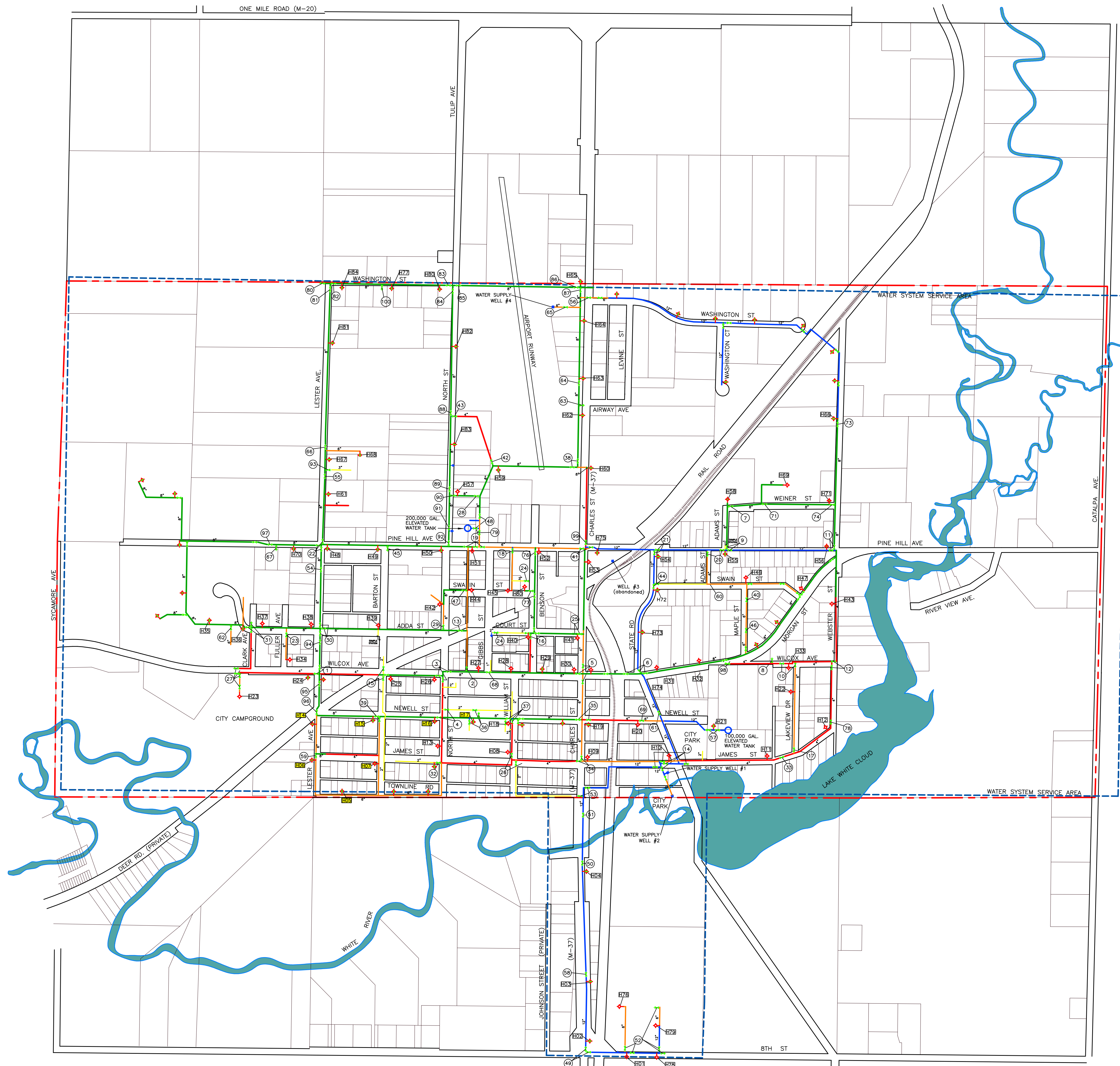

WATER SYSTEM LEGEND

- ↑ BLOW-OFF
- ◆ HYDRANT WITH VALVE
- ◇ HYDRANT
- VALVE
- TANK
- WELL
- SAMPLE STATION
- 4" MAIN SIZE
- ④ VALVE NUMBER/FOR PAGE NUMBER IN VALVE BOOK
- 1-3" WATERMAINS
- 4" WATERMAINS
- 6" WATERMAINS
- 8" WATERMAINS
- 12" WATERMAINS
- Ⓜ H55 HYDRANT NUMBER WITH DRAIN
- Ⓜ H77 HYDRANT NUMBER WITHOUT DRAIN
- WATER SYSTEM SERVICE AREA

WATER SYSTEM NOTES

THE FOLLOWING HYDRANTS NEED TO BE PUMPED DOWN AFTER WINTER USE:
H-05, H-06, H-07, H-14, H-15, H-16, H-17

WATER SYSTEM SUPPLY INFORMATION:
WATER SUPPLY WELL #1
RATED CAPACITY - 250 GPM
TESTED CAPACITY - 280 GPM
(07-27-2016)
PRIMARY POWER SUPPLY - CONSUMERS POWER
BACK UP POWER SUPPLY - PORTABLE GENERATOR

WATER SUPPLY WELL #2
RATED CAPACITY - 350 GPM
TESTED CAPACITY - 345 GPM
(11-01-2016)
PRIMARY POWER SUPPLY - CONSUMERS POWER
BACK UP POWER SUPPLY - PORTABLE GENERATOR

WATER SUPPLY WELL #4
RATED CAPACITY - 400 GPM
TESTED CAPACITY - 470 GPM
(01-31-2013)
PRIMARY POWER SUPPLY - GREAT LAKES ENERGY
BACK UP POWER SUPPLY - PORTABLE GENERATOR